







# LORY - IP 68

Apparecchio in ottone e ghiera in acciaio inox 316L con 1 SuperLED da 1W. Per interni o esterni (IP 68 - 12Vac/dc). Massima profondità di immersione 2 mt. Fissaggio filetto 1" 1/4. Cavo standard 2,80 mt. Peso: 0,620 Kg.

Light spot in brass and brushed stainless steel inox 316L flange with 1 SuperLED of 1W. For indoors or outdoors (IP 68 - 12Vac/dc). Maximum depth immersion 2 mt. Fixing thread 1" 1/4. Standard cable 2,80 mt. Weight: 0,620 Kgs.



Angolo 20° 20° angle beam	Angolo 55° 55° angle beam	Colore Colour
11700	11700/55	
11701	11701/55	
11702	11702/55	
11703	11703/55	
11720	11720/55	
11722	11722/55	

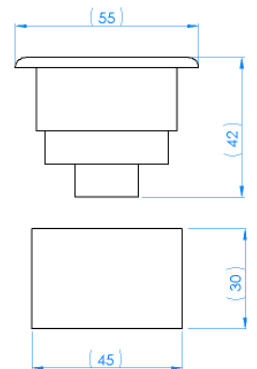

## ACCESSORI AGGIUNTIVI OPTIONAL ACCESSORIES

Manicotto codice MAN1-1/4P  
Pipe union code MAN1-1/4P



Pinza per montaggio Lory codice PML  
Mounting tongs for Lory code PML



# LORY POOL - IP 68

Apparecchio in ottone e ghiera in acciaio inox 316L con 1 SuperLED da 1W. Per installazioni in piscine (IP 68 - 12Vac/dc). Massima profondità di immersione 2 mt. Fissaggio filetto 1" 1/4. Fornito con rondella in inox diam. 100 mm. Cavo standard 2,80 mt. Peso: 0,955 Kg.

Light spot in brass and brushed stainless steel inox AISI 316L with 1 SuperLED of 1W. For pool applications (IP 68 - 12Vac/dc). Maximum depth immersion 2 mt. Fixing thread 1" 1/4. Supplied with stainless inox flange diam. 100 mm. Standard cable 2,80 mt. Weight: 0,955 Kgs.



Angolo 20° 20° angle beam	Angolo 55° 55° angle beam	Colore Colour
11700P	11700P/55	
11701P	11701P/55	
11702P	11702P/55	
11703P	11703P/55	
11720P	11720P/55	
11722P	11722P/55	

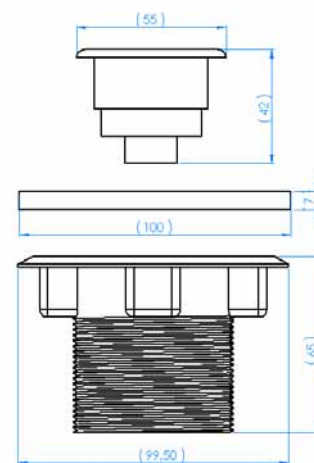

## ACCESSORI AGGIUNTIVI OPTIONAL ACCESSORIES



Pinza per montaggio Lory codice PML  
Mounting tongs for Lory code PML



Bocchetta da piscina  
standard 1" 1/2 codice BOC050F.  
Standard pool pipe union  
1" 1/2 code BOC050F.



Passante da parete codice PCA19  
Wall passage union code PCA19